

An Introduction to Helvar

Helvar

WELLBEING | ENERGY EFFICIENCY | INSIGHTS

A MESSAGE FROM HELVAR CEO

Helvar

Welcome to Helvar

“ Hello, my name is Adel Hattab, and I am the CEO of Helvar. It's my great pleasure to introduce you to our company in a year where we can celebrate an incredible milestone - our 100th anniversary.

At Helvar, we've been on a journey of reinvention since 1921. Starting as a radio manufacturer from a single factory in Finland, we have become a global lighting solution provider across six continents. It would not have been possible to make it this far without our most important asset - our people. The Helvar team, and our global network of over fifty partners, are the true heart of our company. Our collective passion for renewal and innovation has fuelled our continual development and continues to do so every day. I am proud to say that today, as we face the changing needs of our planet, we stand together.

Our vision is 'Turning Everyday Places into Brighter Spaces'. This means that we are determined to create perfectly lit environments designed around the people who use them. It also means that we aim to develop intelligent and future-proof spaces that use data insights to optimise every building over its entire lifetime. This vision solidifies our purpose in positively shaping both our society and our planet as a whole. Our mission is to bring intelligence and insights into every space, improving people's wellbeing and the efficiency of buildings through our world-class lighting solutions. We are committed to leading the way in technological advancement and human-centric design for future generations. I am truly excited about Helvar's future.

We have seen thousands of spectacular projects come to life worldwide, illuminated by our award-winning suite of both wired and wireless lighting solutions, curated by some of the greatest minds this industry has to offer. As we continue to build our legacy at the forefront of the lighting industry, I have no doubt that we will continue to realise our ambitious growth agenda.

We are always looking to partner with the best in the business to achieve this goal. Whether you're a contractor, installer, specifier or designer, we're eager to work with you to accomplish mutual success.

I wish you all a prosperous, safe and successful year ahead, and I welcome you to join us on our journey.

”

Helvar

Adel Hattab

HELVAR CEO



We are

Helvar

Turning Everyday Places into Brighter Spaces

About Helvar

At Helvar, we provide global lighting solutions.

Our heritage is what makes us unique. Within 100 years, our insight has led us to grow from a single factory in Finland to a growing global network with presence in over 80 countries. Our passion is people - our customers, our team and our partners. Working together, we can positively impact sustainability through our products, our solutions and our global projects. Through intelligence and insights, our focus is on improving the wellbeing of people. Innovation is at the heart of what we do. No matter what the next 100 years will bring, we are on a mission to create 'Brighter Spaces' - transforming everyday places into truly intelligent, connected spaces, that are sustainable over their lifetime and optimised for the people who use them.

Here's to the next 100 years!

Why Helvar?

A century of expertise



Born in 1921, we have over 100 years of intelligence, insights and innovation! As founding members of the DALI Alliance, we are at the forefront of new technology and industry advancements.



A truly global network

Worldwide, we serve our customers locally by our sales offices and our global network of over 50 partners, and we're proud to have incredible lighting projects in over 80 countries.

A sustainable future



From providing remote monitoring and maintenance, to using data to predict energy savings and reduce costs by integrating with building systems, our service offerings support buildings throughout their entire life cycle.



An award-winning portfolio

Our products are best-in-class for reliability, compatibility and flexibility. With the extensive selection of advanced lighting solutions and components, we're experts at creating future-proof lighting solutions across a range of applications.

Read our full story at [helvar.com](https://www.helvar.com)



Helvar

INTRODUCING

Imagine

IMAGINE ENDLESS POSSIBILITIES

HELVAR IMAGINE brings wellbeing and intelligence into your space, offering efficiency and scalability for a wide variety of applications. Imagine builds upon industry standards for easy installation and integration to provide a truly leading lighting control and management solution.

What are the benefits of using Helvar Imagine?



Vastly scalable & flexible

With Helvar Imagine, you can create the perfect lighting control system no matter the size of your project - whether it's for a single room, a floor, an entire building, or even multiple buildings across a campus.

With DALI, reconfiguration is easy, and spaces can be adapted without costly rewiring. Helvar Imagine even allows multi-vendor compatibility! This is lighting design without limitations.

Designed for wellbeing

At Helvar, we are human-centric lighting experts. The lighting in spaces where we work, learn, and relax needs to be fine-tuned to our needs to positively impact our mood, productivity and concentration.

Create optimally lit spaces featuring circadian lighting with Helvar's **Light Over Time™** software, and harness the power of Tunable White drivers and modules to achieve truly dynamic lighting.

Efficient & intelligent

Helvar Imagine is designed to reduce energy usage, with features including presence and absence detection. Coupled with **Helvar Insights** reporting, it's possible to fully optimise your space based on how a space is used.

Seamlessly integrated Building Management Systems (BMS) which offer full control and visibility are what makes a smart building truly smart.

Visit helvar.com/imagine to learn more

Imagine

Helvar

IMAGINE ENDLESS POSSIBILITIES

The Helvar Imagine System Architecture

HELVAR IMAGINE is a complete lighting control and management solution. Built on top of open protocols such as DALI-2 and Ethernet, Imagine maximises on industry standards for easy installation and integration. Lighting management is increasingly becoming an important element of intelligent construction. Service and monitoring of lighting from the level of the building management system enables quick access to current energy consumption, working hours and error messages. Automated lighting control in the building improves energy efficiency at the same time increasing the user's work comfort.

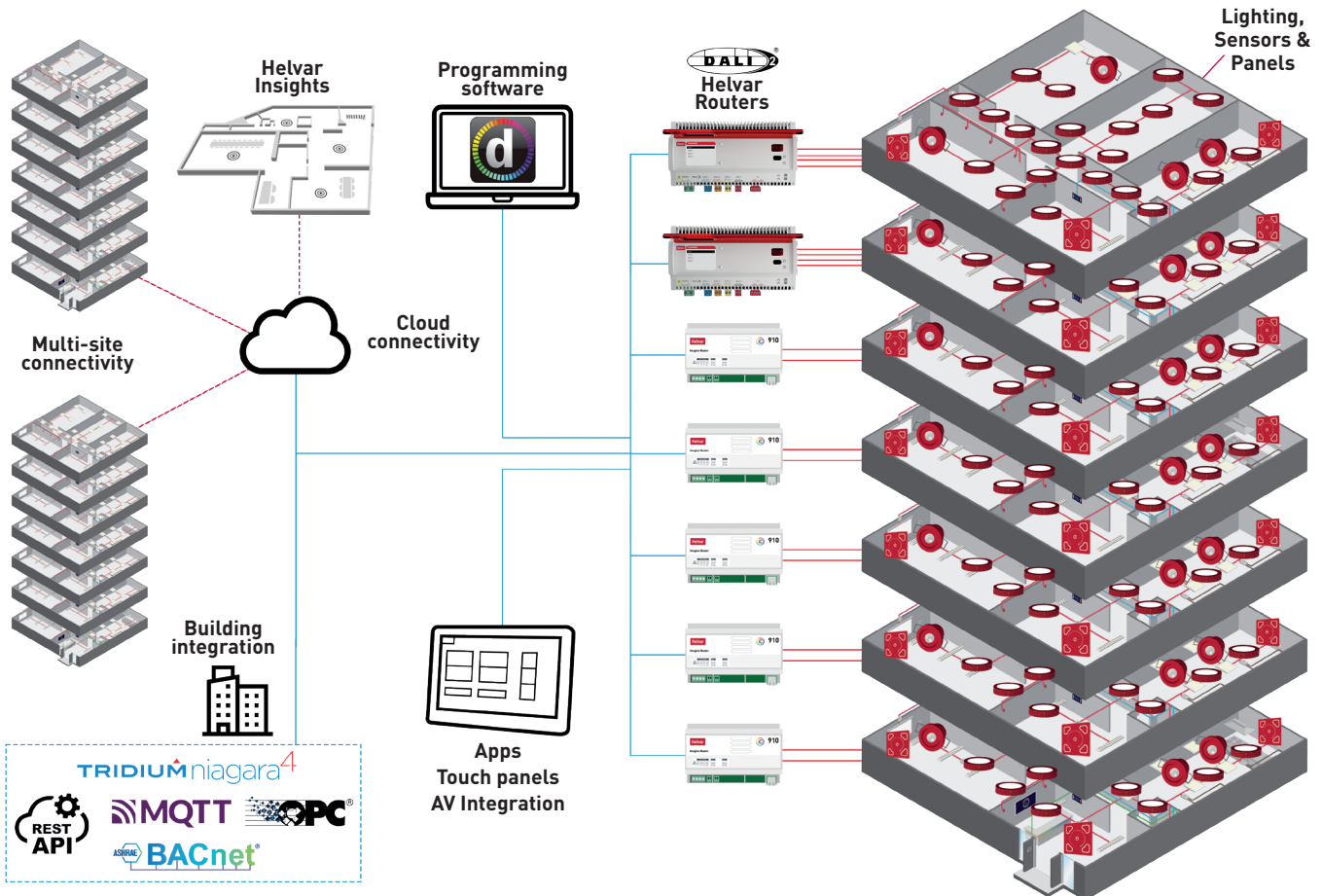

Key products

At Helvar, we offer a full-suite of top-quality products which enable the creation of lighting control systems fit for a wide range of applications.

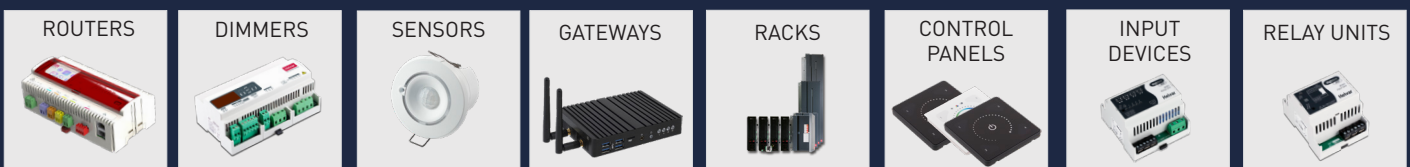

Helvar

INTRODUCING

ActiveAhead™

TRULY INTELLIGENT WIRELESS LIGHTING CONTROLS

HELVAR ACTIVEAHEAD is a truly intelligent and scalable wireless lighting solution. Its unique self-learning capabilities give ultimate efficiency in setup and operations. ActiveAhead will continuously learn and generate insights, maximising positive impact on wellbeing and optimising your ever-evolving building. The perfect solution for offices, warehouses, stairways and parking garages.

What are the benefits?



Self-learning

Wirelessly networked ActiveAhead Nodes use a **smart algorithm** to learn how a space is used. The luminaires collect data from their own sensors as well as from the other luminaires which surround them, and can intelligently adapt lighting levels for a consistent optimal user experience.



Easy to install

Luminaires fitted with ActiveAhead are extremely easy to install. Just fix the luminaires to their intended position and switch on the mains. **No control wiring**, programming or configuration is needed to get started!



Energy saving

In addition to the ultra-efficient DALI Drivers, when compared to LED-based switch luminaires, ActiveAhead offers substantial energy savings. In spaces such as offices and parking garages, ActiveAhead intelligently dims lighting when the space is not actively used.

Helvar ActiveAhead It's as easy as 1, 2, 3...

1	First, choose your ActiveAhead Node: Standard or DALI	2	Next, choose your corresponding driver: Freedom or DALI
			
3	Choose your corresponding sensor: Indoor or Outdoor or DALI	+	Optionally Select a wall panel and/or sensor holder :
			

The all-new ActiveAhead App

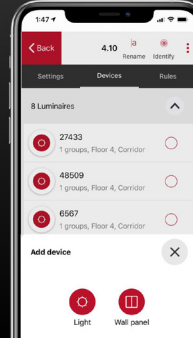
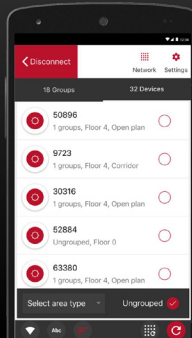
ULTRA-EASY SETUP USING THE MOBILE APP	MANAGE ALL DEVICES IN ONE PLACE	CREATE GROUPS FOR TOTAL CONTROL
		

Visit helvar.com/activeahead to learn more



INTRODUCING

Helvar Insights

BRINGING INTELLIGENCE & INSIGHTS INTO YOUR SPACE

HELVAR INSIGHTS is a scalable cloud-based suite of digital services that take advantage of data gathered from your existing lighting control devices and sensors. This platform provides intelligent insights that can be applied to improve the wellbeing of users, the efficiency of a building and help users achieve their sustainability targets.

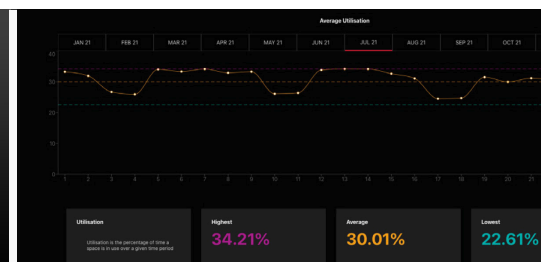
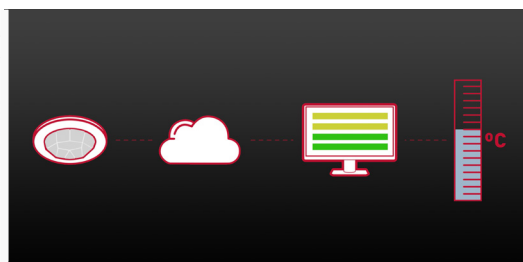
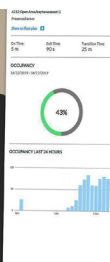
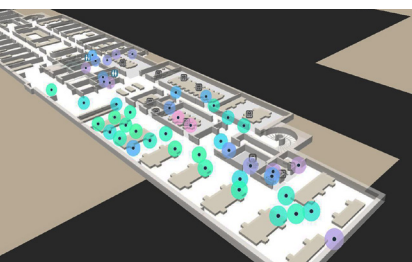

Occupancy heatmaps

Animated heatmaps to visualise how occupants use a building.

Smart system integration

Integrate occupancy data with HVAC and room-booking systems.

Ultimate optimisation

Automated reporting gives visibility on space usage throughout a space.

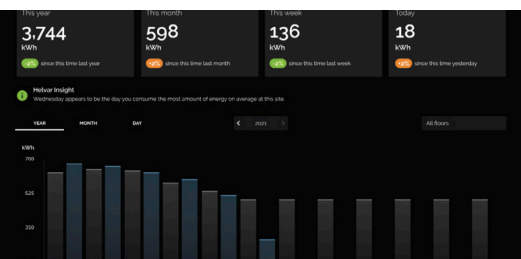

24/7 remote monitoring

The secure, server-less lighting monitoring system - accessible anywhere, anytime.

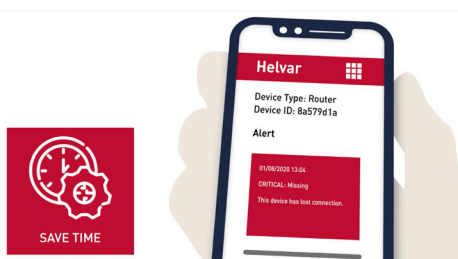

Real-time notifications

Instant e-mail notifications with severity levels to keep you on top of any maintenance issues.

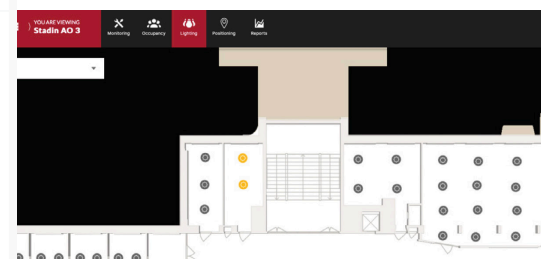

Remote lighting control

Select scenes in real time or create easy-to-use online schedules. Digital lighting control, reimaged.

“ One of the smart building features of the Helvar system is that it enables us to collect occupancy data for all spaces. This helps us understand how our building is used and it’s in line with our smart building ambition - KARI MELANDER, Development Director, Ramboll. ”

Visit helvar.com/helvar-insights to learn more

Helvar

MARKET LEADING

Luminaire Components

ULTIMATE FREEDOM IN DESIGN WITH UNBEATABLE COMPONENTS

LUMINAIRE COMPONENTS are Helvar's foundations in lighting. The Helvar LED offering is perfect for energy efficient, long lasting and high-quality professional lighting applications. World-class LED drivers, modules and accessories provide ultimate design freedom, and have done for over 70 years.

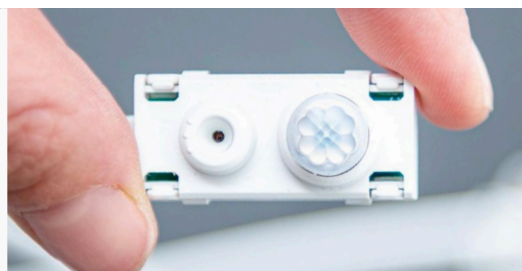

Tunable White

Colour Temperature Control

Tunable White products enable the mixing of warm and cool white light, and the adjustment of light intensity to create energising, relaxing and productive lighting modes. This promotes feelings of well-being for people who spend a large part of their day indoors in artificial light.

Freedom Wireless

Wireless Solution for LED Lighting

Helvar offers a unique wireless lighting control solution: **Freedom**. We want to offer our luminaire manufacturer's a freedom of choice. They can choose from Helvar's own ActiveAhead solution or select an other wireless ecosystem supported by Helvar Freedom drivers.

72 years and counting

Unparalleled Quality

As of 2021, over 450-million luminaire components have been sold around the world - which equates to roughly 81 components for every person in Finland. Helvar components are regarded as best-in-class for reliability, compatibility and flexibility.



LED Drivers

Whether it's dimmable LED lighting covering DALI-2, DALI, Tunable White and 1-10 V LED drivers, drivers for wireless lighting control or non-dimmable drivers for ON/OFF control, Helvar has you covered.



LED Modules

The ever-extending portfolio offers LED module alternatives for high performance, Tunable White and custom made designs. Our linear LED modules are compatible with Zhaga dimensions and LEDiL optics.



Ballasts

Not ready for LED yet? We offer a full range of top quality electronic and magnetic ballasts. Our product portfolio covers components for all possible applications regardless of control method.

Visit helvar.com/luminaire-components to learn more

THOUSANDS OF Case Studies

Helvar



 **MICROSOFT OFFICE**
Sweden



 **VETERINARY UNIVERSITY**
United Kingdom



 **HEYDAR ALIYEV CENTRE**
Azerbaijan

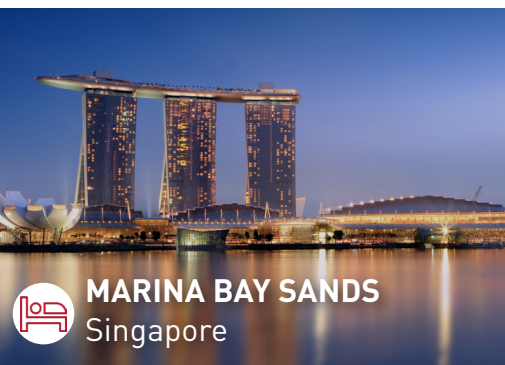

 **MARINA BAY SANDS**
Singapore



 **STATE OFFICE DE KNOOP**
Denmark

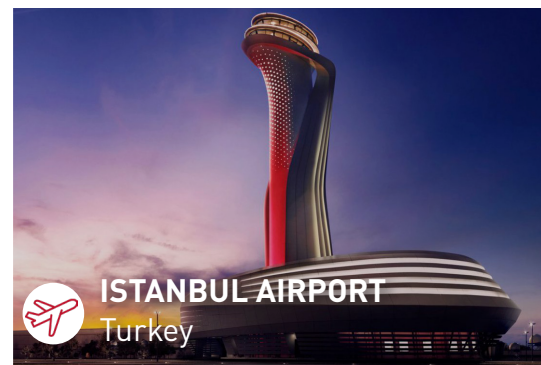

 **ISTANBUL AIRPORT**
Turkey

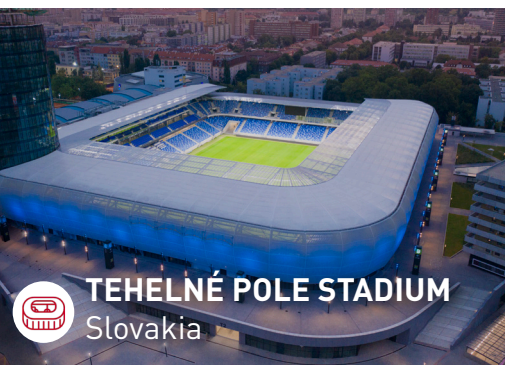

 **TEHELNÉ POLE STADIUM**
Slovakia



 **NATIONAL GALLERY**
United Kingdom



 **DUBAI MALL**
United Arab Emirates



 **KINGS COLLEGE HOSPITAL**
United Arab Emirates



 **HYUNDAI FACTORY**
Czech Republic



 **HARMONY OF THE SEAS**
Marine

Visit helvar.com/case-studies to learn more



“ Smart buildings are here today, but we believe they need to be better than smart. When a building can learn from its senses, think about how it can improve itself over its lifetime, then it will be truly intelligent. ”

THET OO - Director of Wired Solutions, Helvar

We're based in Finland, Sweden and the UK - but we work with Partners all over the world.

FINLAND
HELVAR OY AB,
Keilaranta 5
FI-02150 Espoo
Tel. +358 9 5654 1

SWEDEN
Helvar AB
Åsögatan 155
SE-11632 Stockholm
Tel. +46 8 545 239 70

UNITED KINGDOM
Helvar Ltd
Hawley Mill, Hawley Road
Dartford, Kent, DA2 7SY
Tel. +44 1322 617 200

See what's new at helvar.com

Helvar